

Subsea Data logger

DL-3.0

The Subsea Data logger is proprietary data logger design by DLM for use in the offshore industry. Comprising of multiple on-board sensors and with extra capacity for external mV or mA inputs, the DL-3.0 can sample on-board and external sensors at customisable sample rates of up to 800Hz.

The data logger is housed within a compact stainless steel 316 enclosure with mounting holes for easy integration to existing or new subsea equipment. Ideal for long or short term deployments on offshore and subsea structures, but also ideal for R&D projects where verification data is required to compare against computer models.

Dimensional Data

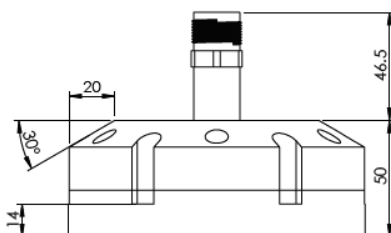
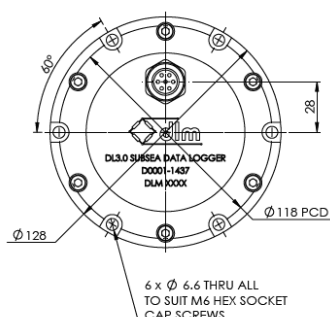

Part Number: 0001-1437

Specification Table

Load Cell Input:	mV/ mA
Load Cell Sensor Range:	0.4 – 5.0 mV/V
Load Cell Bridge Resistance:	350 - 2000Ω
Load Cell Logging Frequency:	22 User selected options between 800Hz and once per hour
Accelerometer Input:	Onboard sensor
Accelerometer Sensor Range:	±125dps, ±250dps, ±500dps, ±1000dps or ±2000dps
Accelerometer Logging Frequency:	17 User selected options between 416Hz and once per hour
Gyroscope Input:	Onboard sensor
Gyroscope Sensor Range:	±125dps, ±250dps, ±500dps, ±1000dps or ±2000dps
Gyroscope Logging Frequency:	17 User selected options between 416Hz and once per hour
Status Input:	Onboard
Status Temperature:	° C
Status Battery Status:	Charge level
Logging Frequency:	8 User selected options between once per 10s and once per hour
Protocol:	RS232 ASCII
Baud Rate:	9600 / 19200 / 38400 / 57600 / 115200
Data Bits:	8
String format:	Configurable
Logging initiation:	PC software, external switch, time delay or set-point trigger
Data download:	Primary USB or secondary RS232
Memory Card:	Sandisk 16Gb MicroSD
Pressure Test:	200Bar
Connector:	CRE Connector with supplied cable and USB Connector
Mounting Information:	6 x 6.6mm thru holes on 118mm PCD
Body Material:	17-4PH Stainless Steel
Material Cert:	3.1 (3.2 upon request)



Features:

- Self-powered internal data logger
- Internal 16Gb SD card for storing logged data
- PC interface to download data in .CSV format
- Subsea connector for mV or mA
- 10.4 Ah litlithium battery

Applications:

- Array cable monitoring
- Monitoring subsea acceleration
- Movement monitoring on Offshore structures